

# RD15BF.2.N系列 - 半封闭内侧打开

## Series of RD15BF.2.N Semi-enclosed type interior opening



闭合状态:  
Opening type:

- Q** 桥式  
Bridge type
- F** 全封闭式  
Enclosed
- BF** 半封闭式  
Semi-enclosed

注: 无字母为普通型  
Note: blank means general type

打开方式:  
Opening way:

- B** 不可打开  
Non-opening
- S** 双侧打开  
Open of both side
- W** 外侧打开  
Exterior opening
- N** 内侧打开  
Interior opening
- F** 无需打开  
Without opening

款式:  
Style:

- Q.B** 桥式不可打开  
Bridge type non-opening
- Q.N** 桥式内侧开  
Bridge type interior opening
- Q.W** 桥式外侧开  
Bridge type exterior opening
- Q.S** 桥式双侧可打开  
Bridge type both side opening
- BF.B** 半封闭不可开  
Semi-enclosed non-opening
- BF.N** 半封闭内侧开  
Semi-enclosed interior opening
- BF.W** 半封闭外侧开  
Semi-enclosed exterior opening
- BFS** 半封闭双侧开  
Semi-enclosed both side opening
- F.N** 封闭内侧开  
Enclosed interior opening
- F.W** 封闭外侧开  
Enclosed exterior opening
- F.S** 封闭双侧开  
Enclosed both side opening

接头类型:  
Bracket type:

- X** 斜型接头  
Oblique bracket
- F** 方型接头  
Square bracket

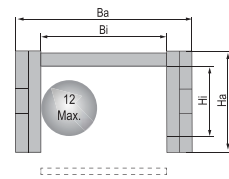
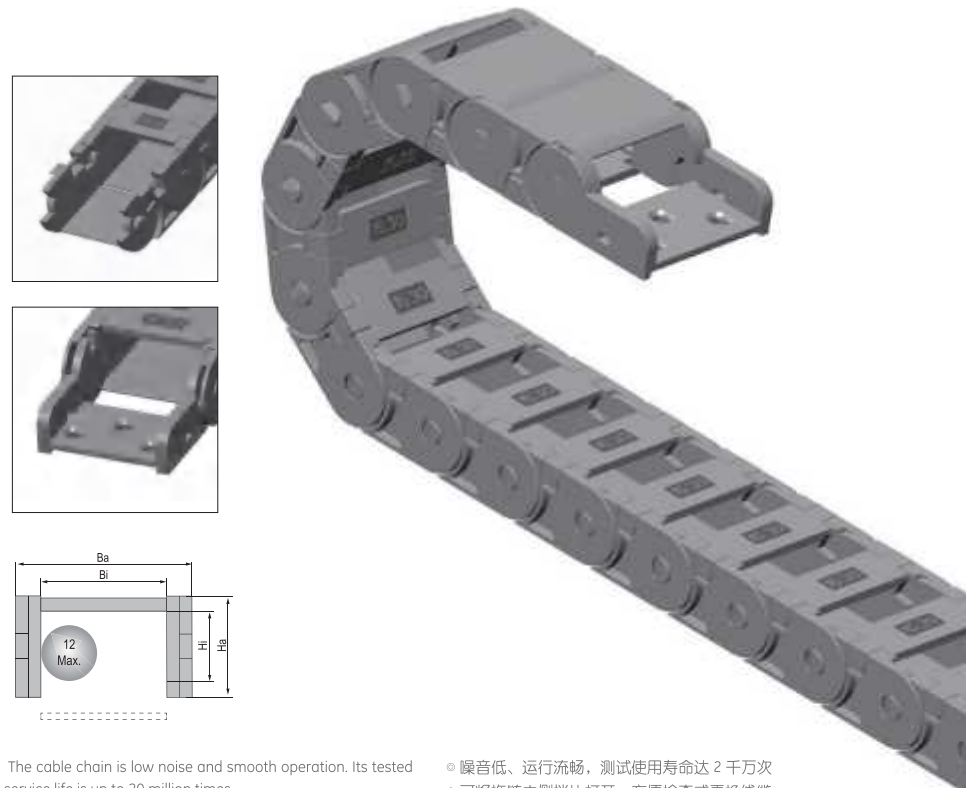

- ◎ The cable chain is low noise and smooth operation. Its tested service life is up to 20 million times.
- ◎ The ledge of cable chain is able to open to inspect or replace cable.
- ◎ The cable chain can mount pectinate plate to fix cable better. (See accessories table)
- ◎ The cable chain is suitable for a diameter of 12mm or less of cable.
- ◎ 噪音低、运行流畅，测试使用寿命达2千万次
- ◎ 可将拖链内侧档片打开，方便检查或更换线缆
- ◎ 可配梳状板，更好的固定线缆（见选配区）
- ◎ 适用于直径12毫米以下线缆

### 主要技术参数 Basic technical data

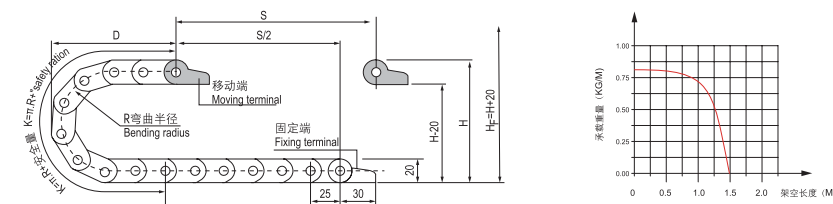

节距=25mm, 每米节数=40, 链长=S/2+K, S=行程距离, K=π.R+“安全量”  
Pitch=25mm, link per meter=40, length of chain=S/2+K, S=stroke, K=π.R+“safety ration”

	R	28	38	48
H	76	96	116	
D	63	73	83	
K	150	175	225	

安装实际高度:H<sub>1</sub>=H+20mm(负载 0.3kg/m)  
Actual mounting height:H<sub>1</sub>=H+20mm(load 0.3kg/m)

### RD15BF.2.N系列 - 半封闭内侧打开 Series of RD15BF.2.N-Semi-enclosed type interior opening

示意图 Drawing

选配区 Accessories table

RD15.1.30-SZB 梳状板 Pectinate plate  
RD15.1.40-SZB 梳状板 Pectinate plate

系列号 Series No.	内高 Hi	内宽 Bi	外高 Ha	外宽 Ba	款式 Styles	弯曲半径 Bending radius R	固定接头类型及参数 Bracket type and parameters								代号 No.
							可配接头类型 Applicable bracket type	孔径 Bore diameter Φ1	孔距 (mm) hole distance						
									A	B	C	D	E	F	
RD15BF.2.30N	15	30	20	41	BF.N	38,48	X <sub>3</sub>	4.2	A1=8 A2=9	22	30		7	41	RD15BF.2.30N-XJT
RD15BF.2.40N	15	40	20	51	BF.N	28	X <sub>3</sub>	4.2*7L	8	28.5	30		7	51	RD15BF.2.40N-XJT

注: N表示内侧打开  
Note: N indicates that the interior opening

### 固定接头类型及参数 Fix bracket type and parameters (见表格 See table)

X<sub>3</sub>型接头 X<sub>3</sub> type bracket

### 订货示例 Order Sample

示例 拖链内高15mm、内宽30mm、半径38mm、长度1米/40节 (Sample: inner height 15mm, inner width 30mm, radius 38mm, length 1 meter /40 links)

拖链 Chain RD15BF.2.30N R38 1000mm/40 Links

接头 Bracket RD15BF.2.30N-XJT 副 (Set)

配件 Accessories

注: 可根据客户要求定制各种规格。 Note: Various sizes can be customized according to customer requirements.